

# BROOKWOOD BUSINESS PARK

10708 GRANITE STREET, SUITE K | CHARLOTTE, NC 28273



## FOR LEASE **±25,600 SF** WAREHOUSE SPACE IN SOUTHWEST CHARLOTTE

- ±1,186 square feet of office
- Six (6) 8' x 10' Dock High Doors
- One (1) 12' x 14' Drive-In Door
- 24' clear height
- Rear load facility
- Easy access to Westinghouse Boulevard
- Strategic distribution location; convenient to I-77, I-485 and numerous amenities
- Located in Brookwood Business Park, a master planned institutional quality park in Southwest Charlotte

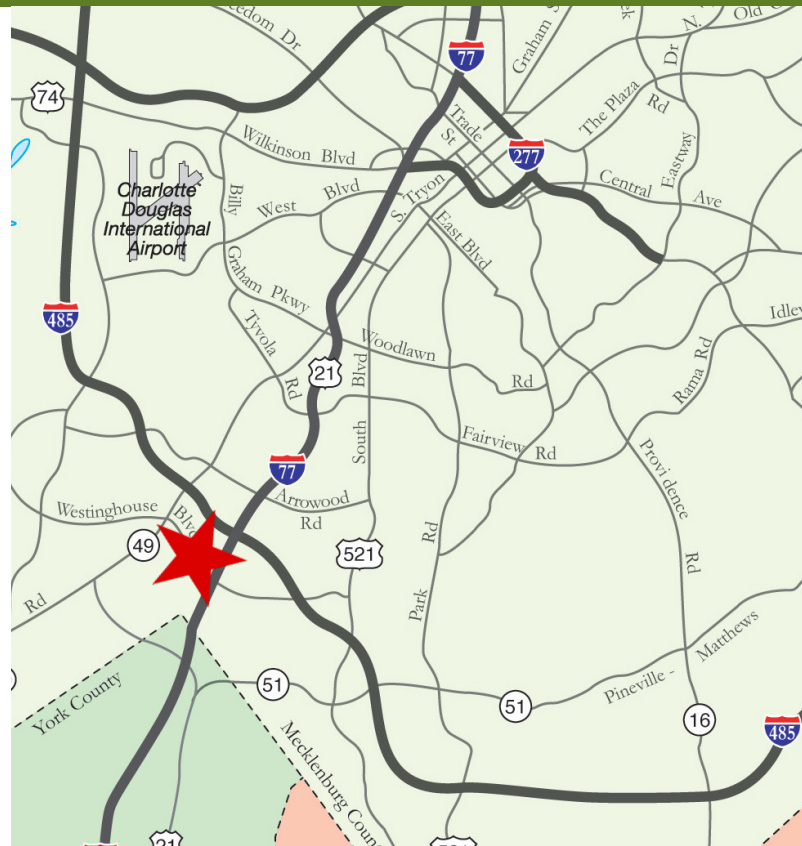

FOR MORE INFORMATION, CONTACT:

**TIM ROBERTSON**

704.926.1405 (d) | 704.597.7757 (m)

[tim.robertson@beacondevelopment.com](mailto:tim.robertson@beacondevelopment.com)

500 East Morehead Street | Suite 200 | Charlotte, NC 28202

**JACK RIAZZI**

704.926.1412 (d) | 336.608.2985 (m)

[jack@beacondevelopment.com](mailto:jack@beacondevelopment.com)

500 East Morehead Street | Suite 200 | Charlotte, NC 28202



# BROOKWOOD BUSINESS PARK

10708 GRANITE STREET, SUITE K | CHARLOTTE, NC 28273

## FLOOR PLAN:

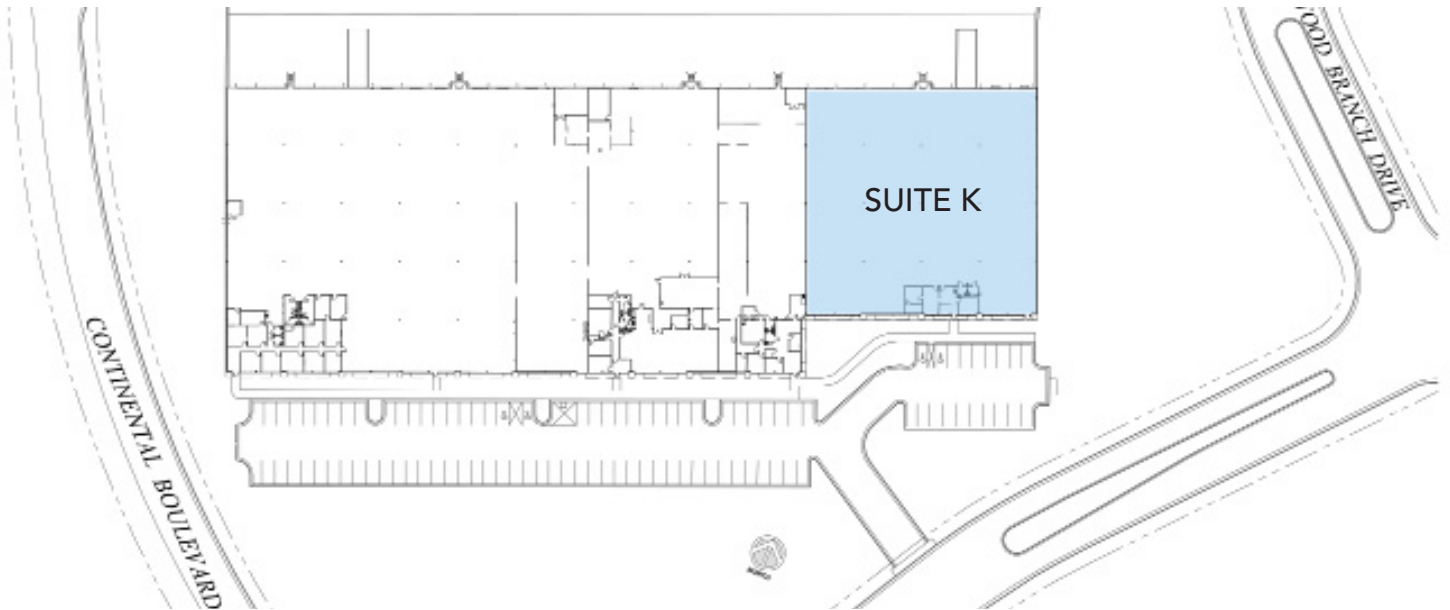
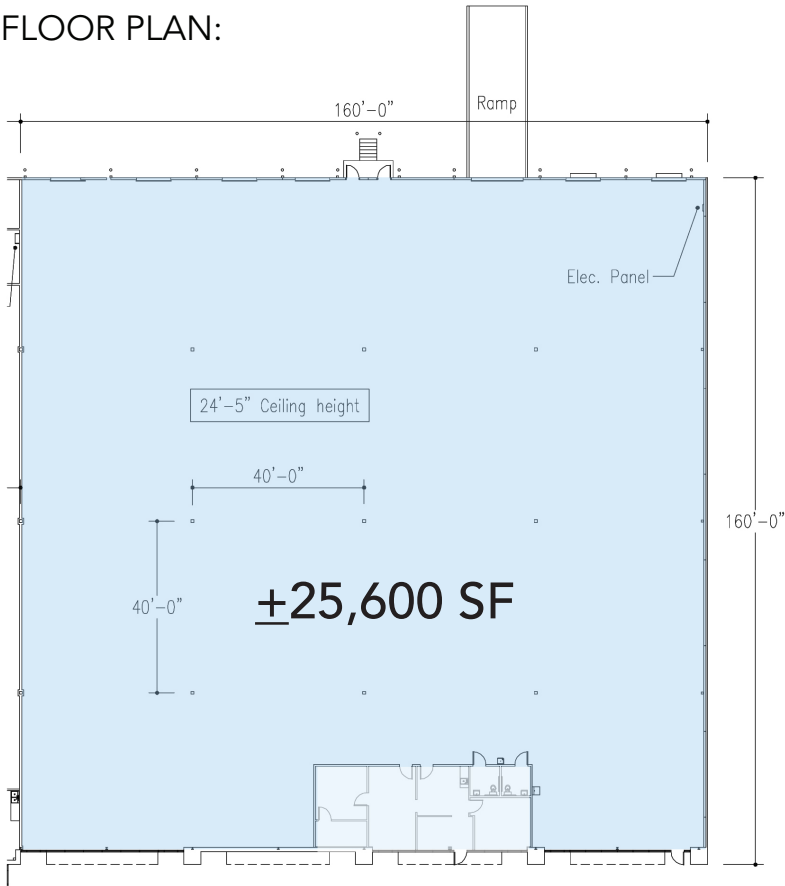

FOR MORE INFORMATION, CONTACT:

**TIM ROBERTSON**

704.926.1405 (d) | 704.597.7757 (m)

[tim.robertson@beacondevelopment.com](mailto:tim.robertson@beacondevelopment.com)

500 East Morehead Street | Suite 200 | Charlotte, NC 28202

**JACK RIAZZI**

704.926.1412 (d) | 336.608.2985 (m)

[jack@beacondevelopment.com](mailto:jack@beacondevelopment.com)

500 East Morehead Street | Suite 200 | Charlotte, NC 28202



**BEACON  
PARTNERS**