

BROOKWOOD BUSINESS PARK

10708 GRANITE STREET, SUITE K | CHARLOTTE, NC 28273



FOR LEASE **±25,600 SF** WAREHOUSE SPACE IN SOUTHWEST CHARLOTTE

- ±1,186 square feet of office
- Six (6) 8' x 10' Dock High Doors
- One (1) 12' x 14' Drive-In Door
- 24' clear height
- Rear load facility
- Easy access to Westinghouse Boulevard
- Strategic distribution location; convenient to I-77, I-485 and numerous amenities
- Located in Brookwood Business Park, a master-planned institutional quality park in Southwest Charlotte



FOR MORE INFORMATION, CONTACT:

TIM ROBERTSON

704.926.1405 (d) | 704.597.7757 (m)

tim.robertson@beacondevelopment.com

500 East Morehead Street | Suite 200 | Charlotte, NC 28202



All information regarding the property was obtained from sources deemed reliable but no warranty or representation is made of the accuracy thereof, and the property is subject to prior sale, lease or withdrawal.

BROOKWOOD BUSINESS PARK

10708 GRANITE STREET, SUITE K | CHARLOTTE, NC 28273

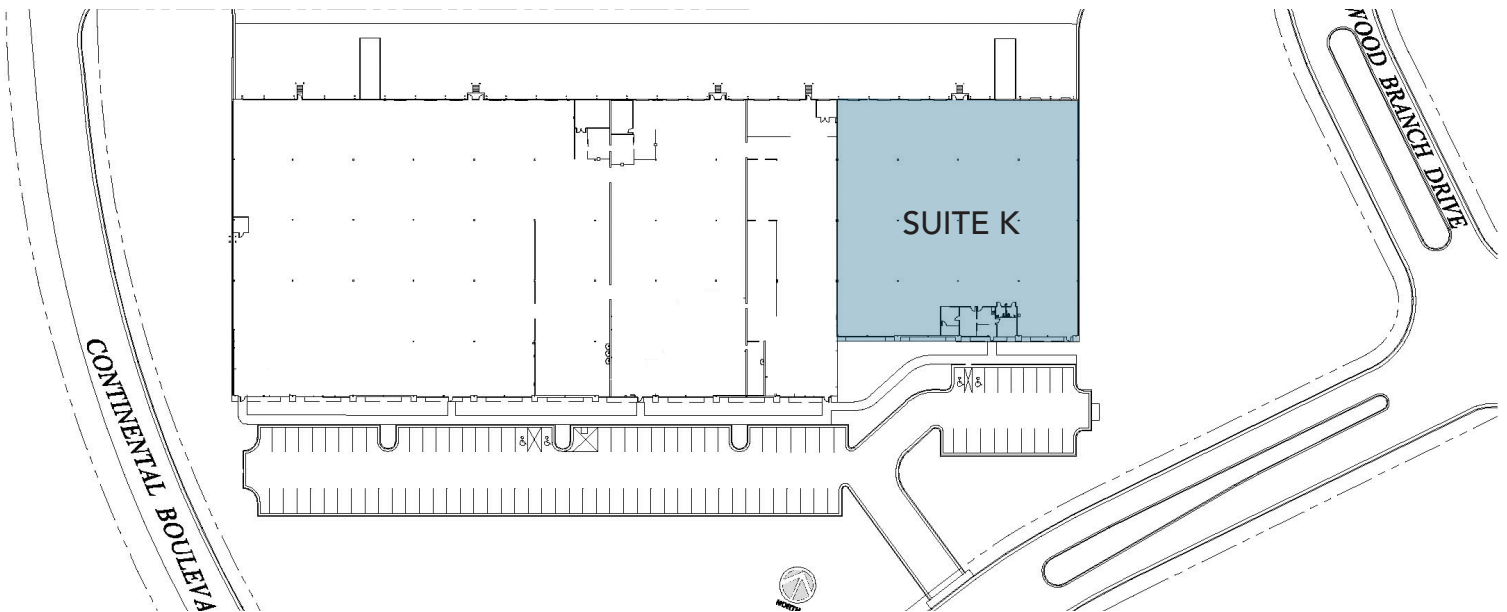
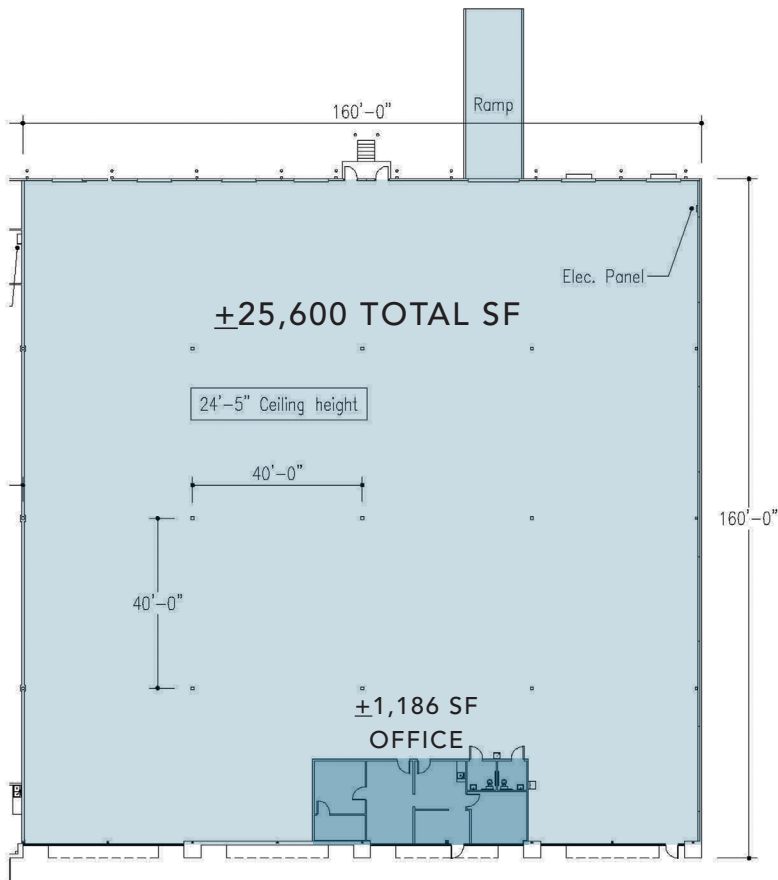

FOR MORE INFORMATION, CONTACT:

TIM ROBERTSON

704.926.1405 (d) | 704.597.7757 (m)

tim.robertson@beacondevelopment.com

500 East Morehead Street | Suite 200 | Charlotte, NC 28202



All information regarding the property was obtained from sources deemed reliable but no warranty or representation is made of the accuracy thereof, and the property is subject to prior sale, lease or withdrawal.