

# ±6,000 SF WAREHOUSE FOR LEASE | CENTRAL CHARLOTTE

ATANDO BUSINESS PARK | 1700 TOAL STREET | CHARLOTTE, NC 28206



## FEATURES:

- ±6,000 SF single tenant facility on ±.65 acre
- ±1,026 SF of office space
- Side load, free-standing building with fenced outside storage
- One (1) 10' x 12' Drive-In Door
- 13' - 14' clear height
- Solid brick on block construction
- Professional park environment
- Direct access to the park from I-77 at Atando/LaSalle (Exit 12)
- Central Charlotte location with immediate access to I-85 (via N. Graham St./Exit 40), the CBD, and UPS facility

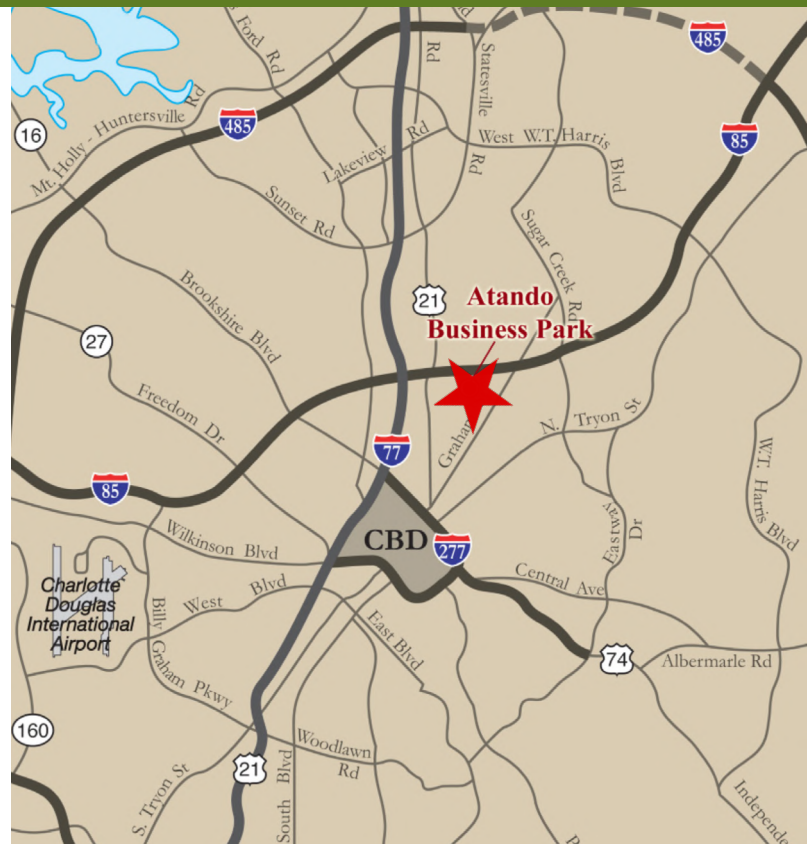

FOR MORE INFORMATION, CONTACT:

**ALEX HABECKER**

704.926.1412 (d) | [alex@beacondevelopment.com](mailto:alex@beacondevelopment.com)

500 East Morehead Street | Suite 200 | Charlotte, NC 28202

[www.beacondevelopment.com](http://www.beacondevelopment.com)



# ±6,000 SF WAREHOUSE FOR LEASE | CENTRAL CHARLOTTE

ATANDO BUSINESS PARK | 1720 TOAL STREET | CHARLOTTE, NC 28206

## FLOOR PLAN:

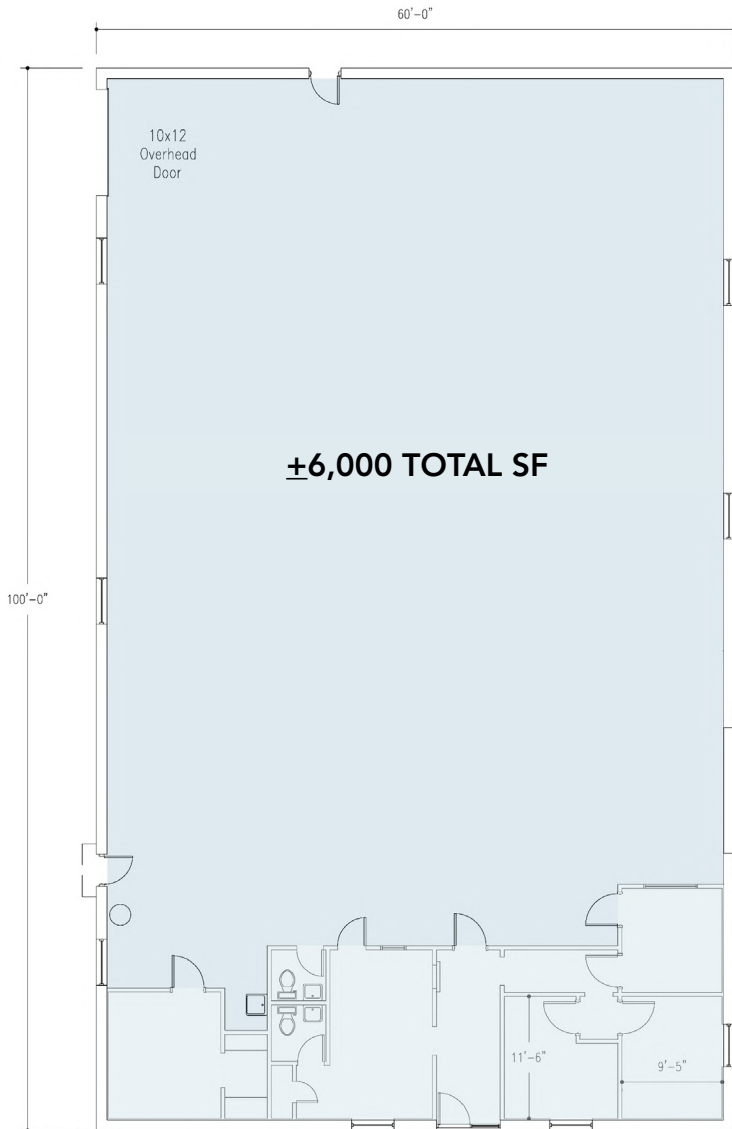

FOR MORE INFORMATION, CONTACT:

**ALEX HABECKER**

**704.926.1412 (d) | [alex@beacondevelopment.com](mailto:alex@beacondevelopment.com)**

500 East Morehead Street | Suite 200 | Charlotte, NC 28202

[www.beacondevelopment.com](http://www.beacondevelopment.com)

