

±15,035 SF | FREE-STANDING FACILITY FOR LEASE | CENTRAL CHARLOTTE

ATANDO BUSINESS PARK | 1720 TOAL STREET | CHARLOTTE, NC 28206



FEATURES :

- Zoned I-2 with fenced outdoor storage
- ±15,035 SF, free-standing facility
- ±2,576 SF of office
- Renovations complete: lights, paint and flooring
- Two (2) 10' x 10' Dock High Doors
- Professional park environment
- Direct access to the park from I-77 at Atando/LaSalle (Exit 12)
- Ideal Central Charlotte location:
 - ±0.5 miles to UPS facility
 - ±1.0 miles to I-85
 - ±2.0 miles to I-77
 - ±2.0 miles to Charlotte CBD

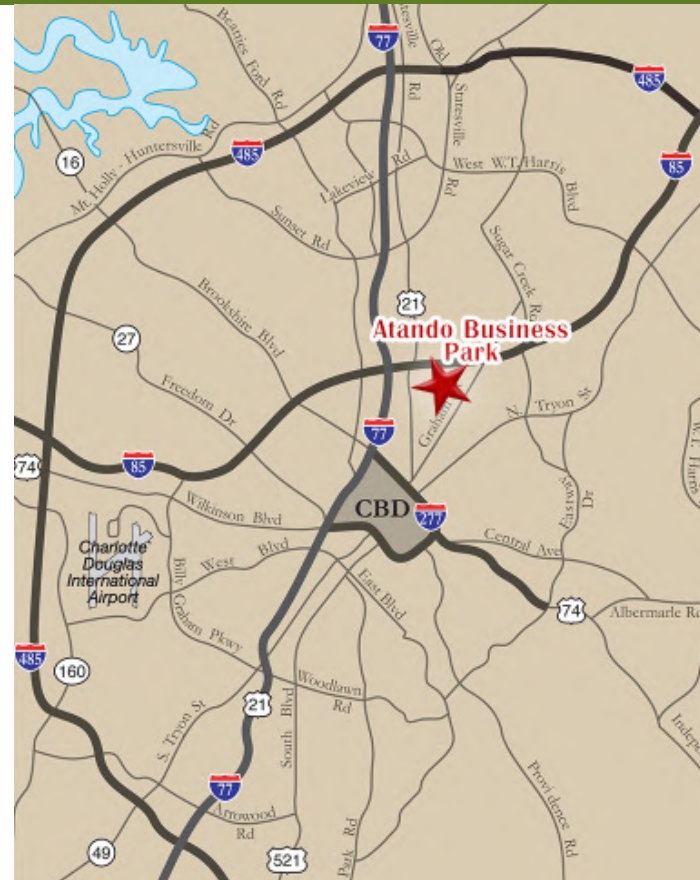

FOR MORE INFORMATION, CONTACT:

JACK RIAZZI

704.926.1404 (d) | kidwell@beacondevelopment.com

500 E. Morehead Street, Suite 200 | Charlotte, NC 28202

www.beacondevelopment.com

All information regarding the property was obtained from sources deemed reliable but no warranty or representation is made of the accuracy thereof, and the property is subject to prior sale, lease or withdrawal.



±15,035 SF | FREE-STANDING FACILITY FOR LEASE | CENTRAL CHARLOTTE

ATANDO BUSINESS PARK | 1720 TOAL STREET | CHARLOTTE, NC 28206

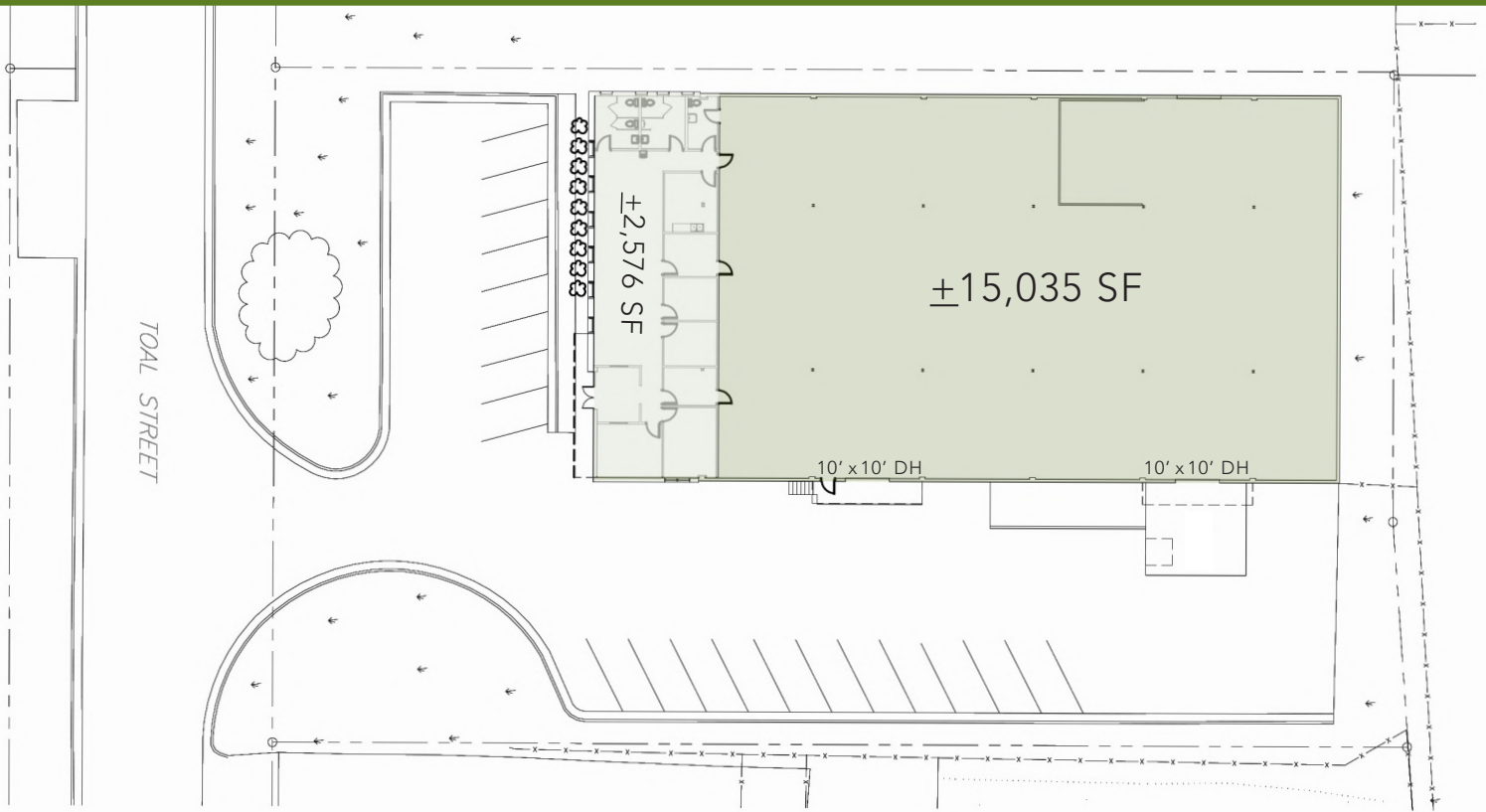

ATANDO BUSINESS PARK:



FOR MORE INFORMATION, CONTACT:

PETE KIDWELL

704.926.1404 (d) | kidwell@beacondevelopment.com

500 E. Morehead Street, Suite 200 | Charlotte, NC 28202

www.beacondevelopment.com

