

# COMMERCE PARK | ±48,000 - ±136,000 WAREHOUSE | FOR LEASE

2101 WESTINGHOUSE BLVD, SUITE A-B | CHARLOTTE, NC 28273



## FEATURES:

- ±48,000 SF - ±136,000 SF
- ±9,006 SF of office
- Rail served by Norfolk Southern
- 16 dock high doors, 11 rail doors
- ESFR sprinkler system
- 28' ceiling height
- 40 x 40' column spacing
- I-2 zoning
- Located in Commerce Park, a master-planned, institution quality park in Southwest Charlotte, convenient to I-77, I-485 and Charlotte Douglas Airport



FOR MORE INFORMATION, CONTACT:

**TIM ROBERTSON**

704.926.1405 (d) 704.654.9880 (m)

[tim.robertson@beacondevelopment.com](mailto:tim.robertson@beacondevelopment.com)

500 East Morehead Street | Suite 200 | Charlotte, NC 28202

[www.beacondevelopment.com](http://www.beacondevelopment.com)



# COMMERCE PARK | ±48,000 - ±136,000 WAREHOUSE | FOR LEASE

2101 WESTINGHOUSE BLVD, SUITE A-B | CHARLOTTE, NC 28273

## FLOOR PLAN:

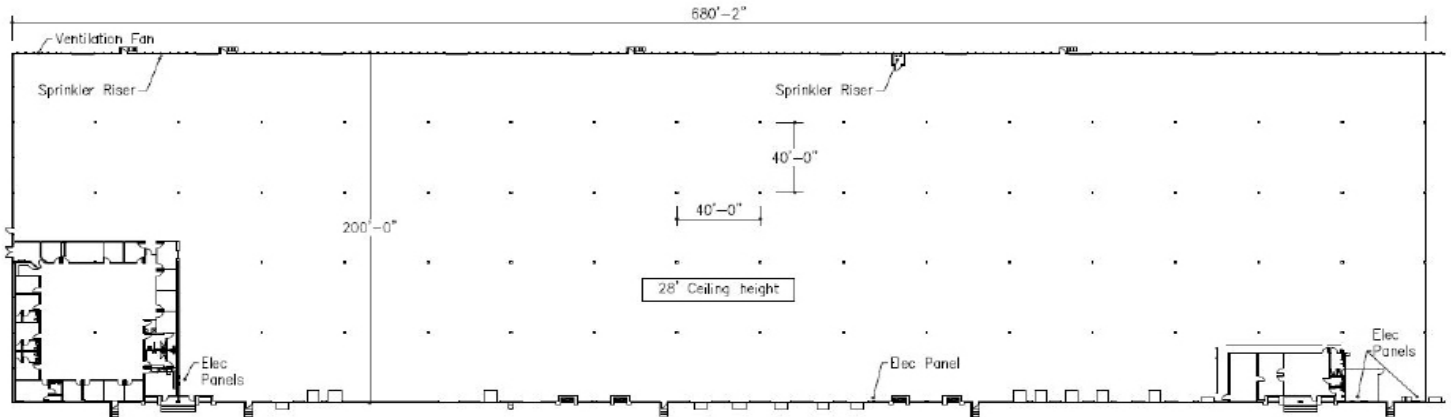

## SITE PLAN:

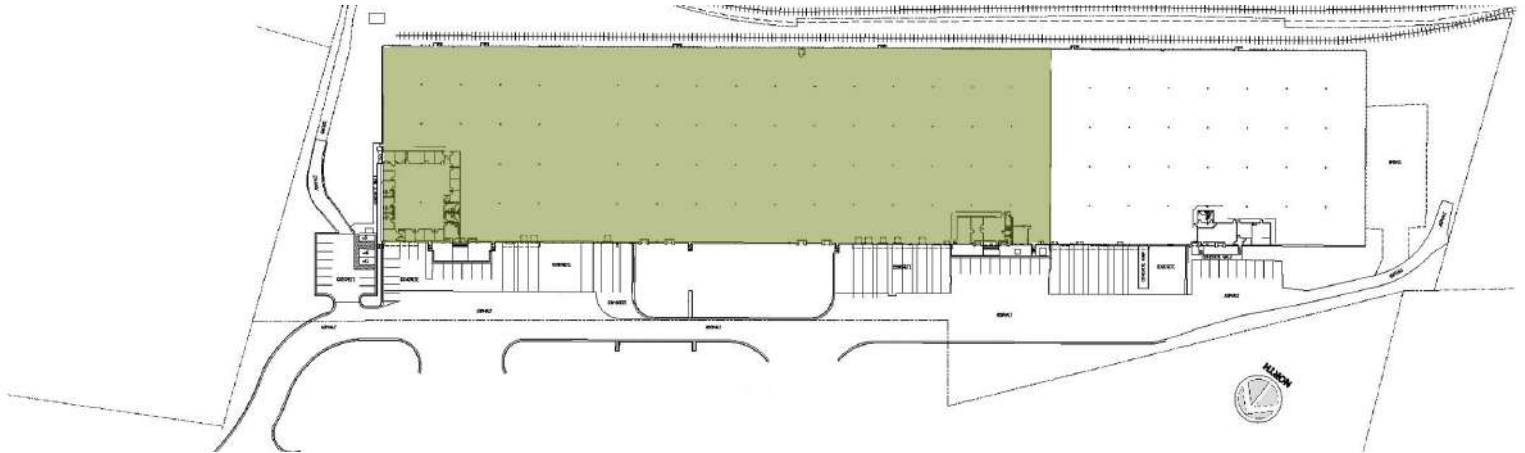

## AERIALS:



FOR MORE INFORMATION, CONTACT:

**TIM ROBERTSON**

704.926.1405 (d) 704.654.9880 (m)

[tim.robertson@beacondevelopment.com](mailto:tim.robertson@beacondevelopment.com)

500 East Morehead Street | Suite 200 | Charlotte, NC 28202

[www.beacondevelopment.com](http://www.beacondevelopment.com)



**BEACON  
PARTNERS**

All information regarding the property was obtained from sources deemed reliable but no warranty or representation is made of the accuracy thereof, and the property is subject to prior sale, lease or withdrawal.