

# 2725 WESTINGHOUSE BLVD | SUITE 300

CHARLOTTE, NC 28273

MAPLECREST INDUSTRIAL CENTER | SOUTH WEST SUBMARKET



## 2,400 SF AVAILABLE FOR LEASE

- 2,400 SF available with 520 SF of office
- One dock-high door (9' x 10')
- One drive-in door (12' x 14')
- 18' clear height
- ML-2 zoning
- Wet sprinkler
- Ample parking and gated truck court
- Ideal Central Charlotte location:
  - ±4 minutes to I-485
  - ±5 minutes to I-77
  - ±15 minutes to Charlotte Int'l Airport
  - ±15 minutes to Charlotte CBD

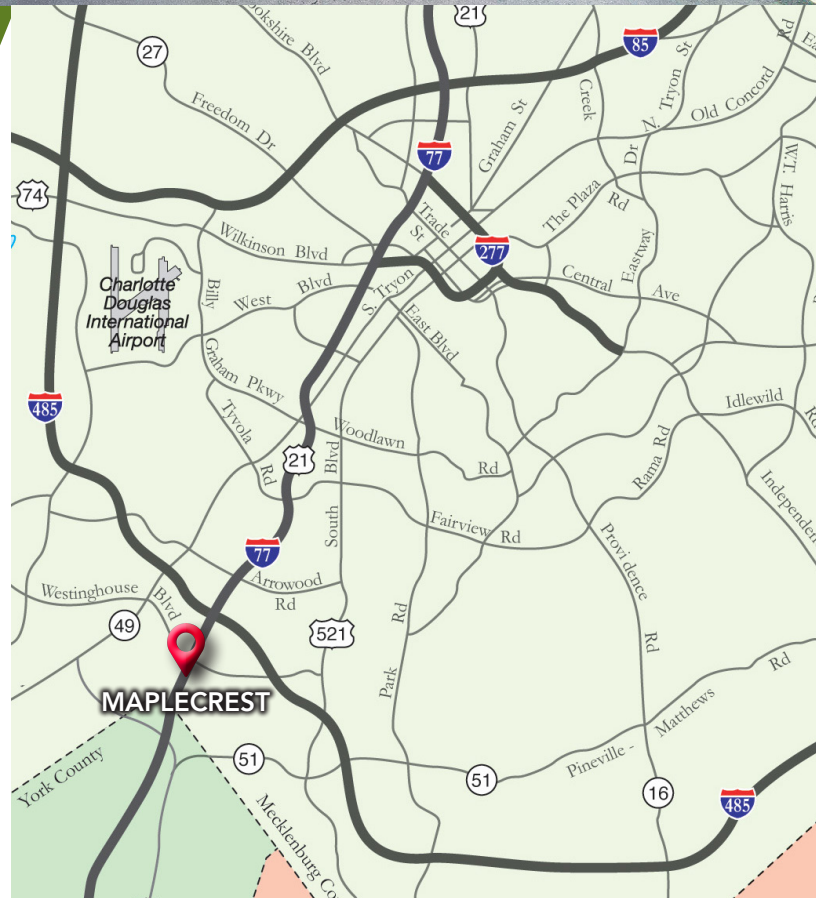

**ALEX HABECKER**

704.926.1412 (d) 407.473.0051 (m)

[alex@beacondevelopment.com](mailto:alex@beacondevelopment.com)

# 2725 WESTINGHOUSE BLVD | SUITE 300

CHARLOTTE, NC 28273

MAPLECREST INDUSTRIAL CENTER | SOUTH WEST SUBMARKET

## AERIAL & SITE PLAN

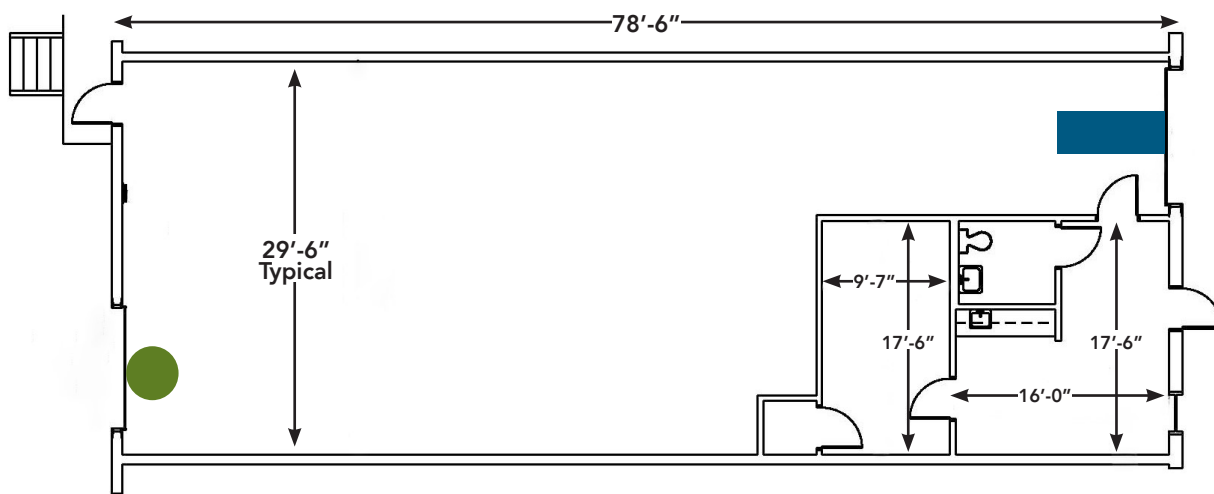
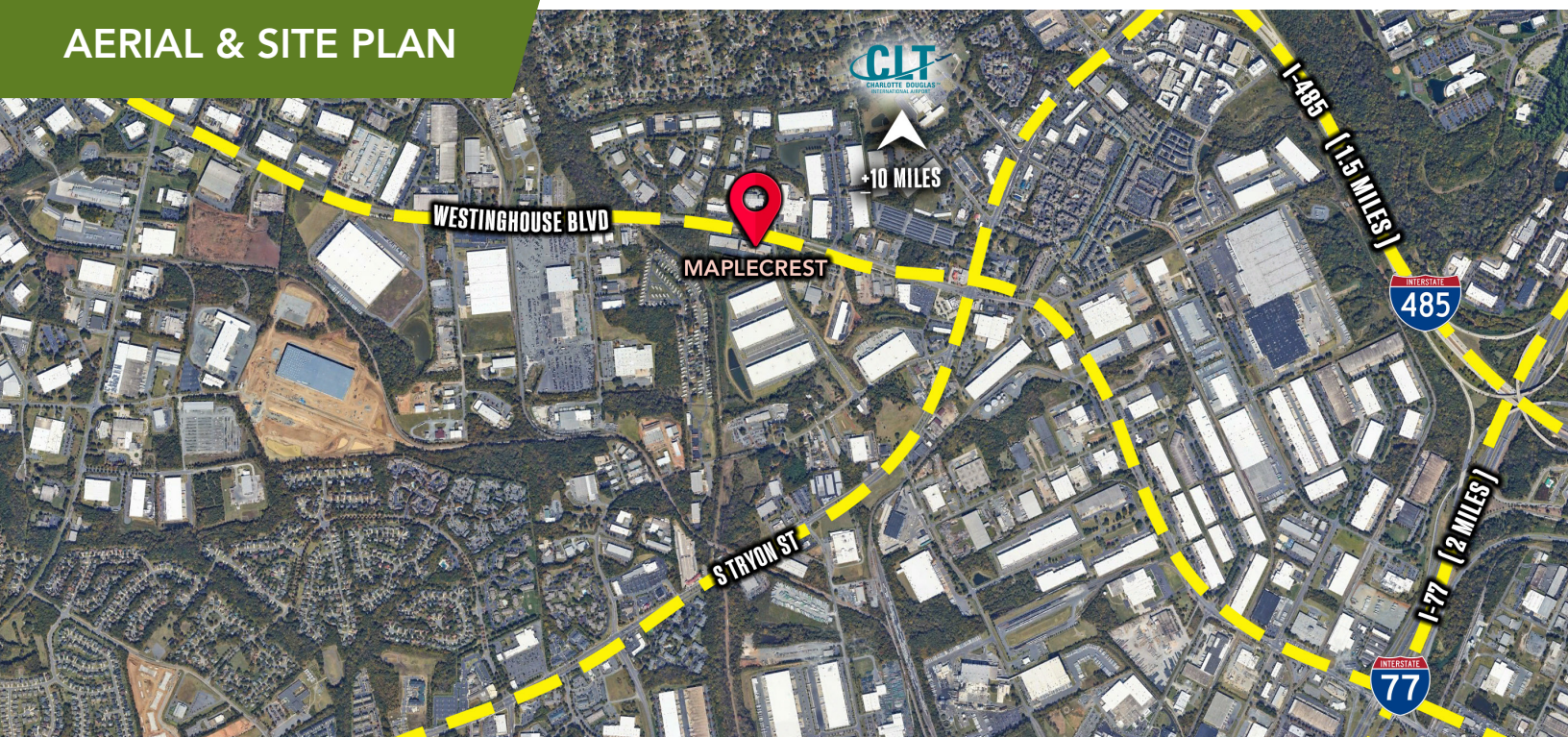

● = Dock-high door    ■ = Drive-in door

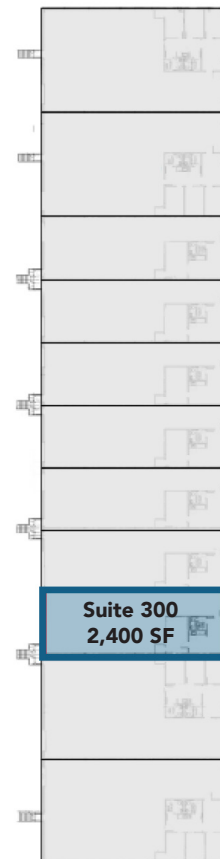

Suite 300  
2,400 SF