

±36,031 SF WAREHOUSE ON 7.02 ACRES

7504 PRECISION DRIVE | RALEIGH, NC 27617



FEATURES:

- 7.02 acre site
- Secured large paved truck court & outside storage/trailer parking lot
- 5,704 square feet of office space
- IX-3-PK Zoning
- ESFR Sprinkler
- 20' - 30' clear height
- New LED lighting throughout warehouse and office
- Immediate access to major traffic arteries via I-540, I-40, and Hwy 70
- Located approximately 3 miles from RDU International Airport via Glenwood Avenue

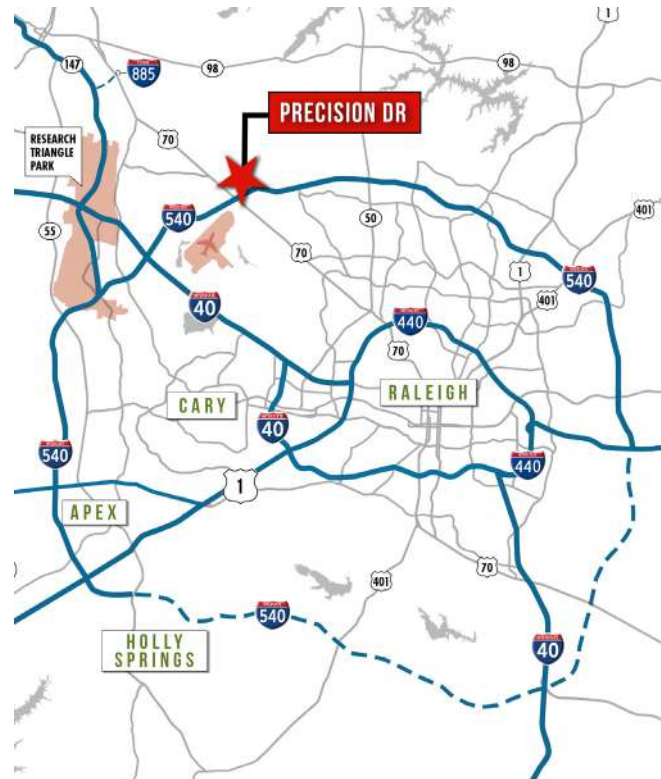

FOR MORE INFORMATION, CONTACT:

TIM ROBERTSON

704.926.1405 (o) | tim.robertson@beacondevelopment.com

500 East Morehead Street, Suite 200 | Charlotte, NC 28202

www.beacondevelopment.com

WALKER GORHAM

919.261.7494 (o) | walker@beacondevelopment.com

702 Oberlin Road, Suite 430 | Raleigh, NC 27605

www.beacondevelopment.com



±36,031 SF WAREHOUSE ON 7.02 ACRES

7504 PRECISION DRIVE | RALEIGH, NC 27617

SITE AERIAL:



FOR MORE INFORMATION, CONTACT:

TIM ROBERTSON

704.926.1405 (o) | tim.robertson@beacondevelopment.com

500 East Morehead Street, Suite 200 | Charlotte, NC 28202

www.beacondevelopment.com

WALKER GORHAM

919.261.7494 (o) | walker@beacondevelopment.com

702 Oberlin Road, Suite 430 | Raleigh, NC 27605

www.beacondevelopment.com



All information regarding the property was obtained from sources deemed reliable but no warranty or representation is made of the accuracy thereof, and the property is subject to prior sale, lease or withdrawal.

±36,031 SF WAREHOUSE ON 7.02 ACRES

7504 PRECISION DRIVE | RALEIGH, NC 27617

BUILDING PLAN:

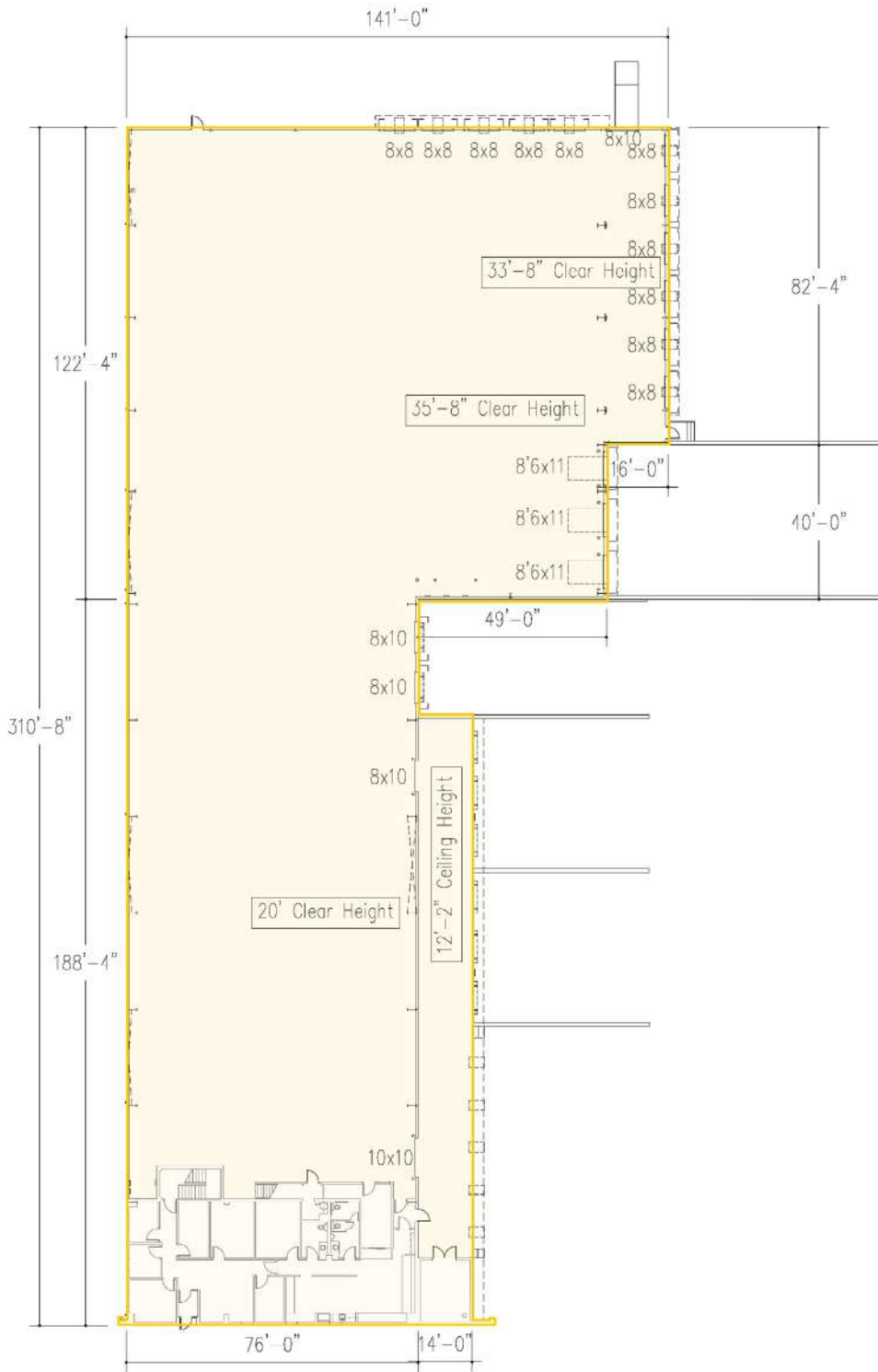

FOR MORE INFORMATION, CONTACT:

TIM ROBERTSON

704.926.1405 (o) | tim.robertson@beacondevelopment.com

500 East Morehead Street, Suite 200 | Charlotte, NC 28202

www.beacondevelopment.com

WALKER GORHAM

919.261.7494 (o) | walker@beacondevelopment.com

702 Oberlin Road, Suite 430 | Raleigh, NC 27605

www.beacondevelopment.com

