

801 E MOREHEAD STREET

801 EAST MOREHEAD STREET | 2ND FLOOR | CHARLOTTE, NC 28202



ENTIRE OFFICE FLOOR FOR LEASE
IN MIDTOWN

±10,607 SF

- Private offices with floor-to-ceiling glass windows; Open area workspace in the middle
- Access to signalized light on E. Morehead Street
- Within walking distance to Atrium Health's Main Campus and Little Sugar Creek Greenway
- Monument signage opportunity; Excellent visibility
- Free & secured surface parking
- Numerous amenities located within immediate area, including restaurants, retail (Metropolitan) and the Dowd YMCA
- Minutes from I-77, I-277, and Uptown Charlotte
- Beacon Partners owns, leased and manages over 1 million in the Midtown and South End areas



FOR MORE INFORMATION, CONTACT:

ERIN SHAW

704.926.1414 (d) | erin@beacondevelopment.com

500 East Morehead Street | Suite 200 | Charlotte, NC 28202

www.beacondevelopment.com



801 E MOREHEAD STREET

801 EAST MOREHEAD STREET | 2ND FLOOR | CHARLOTTE, NC 28202

SUITE 200: ±10,607 SF

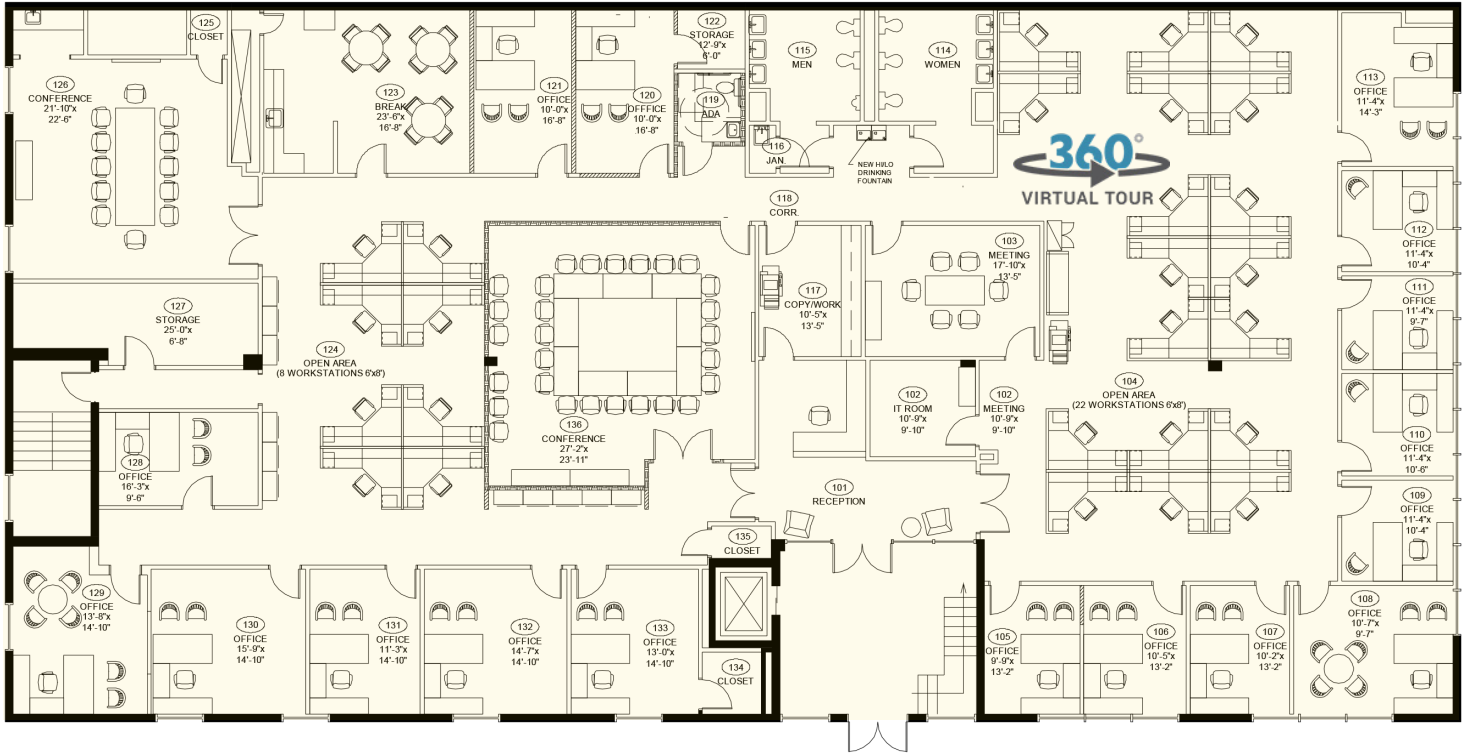

FOR MORE INFORMATION, CONTACT:

ERIN SHAW

704.926.1414 (d) | erin@beacondevelopment.com

500 East Morehead Street | Suite 200 | Charlotte, NC 28202

www.beacondevelopment.com

