

900 BAXTER STREET

CHARLOTTE, NC 28204

MIDTOWN CREATIVE OFFICE
FULL BUILDING AVAILABLE





- $\pm 19,430$ total SF, 1 story building for a single tenant user available September 2020
- Ideally located just outside of Uptown for superior access
- Proximate to I-77 and I-277 for efficient commute and airport access
- Situated on the corner of S McDowell and Baxter for prominent McDowell Street signage opportunity
- Numerous nearby amenities including the DOWD YMCA, Little Sugar Creek Greenway, Atrium Health's Main Campus, and the Metropolitan
- Parking ratio 3 per 1,000 surface parking
- Beacon Partners leases and manages over 1 million SF of office space in Midtown and South End

+/-19,430 SF

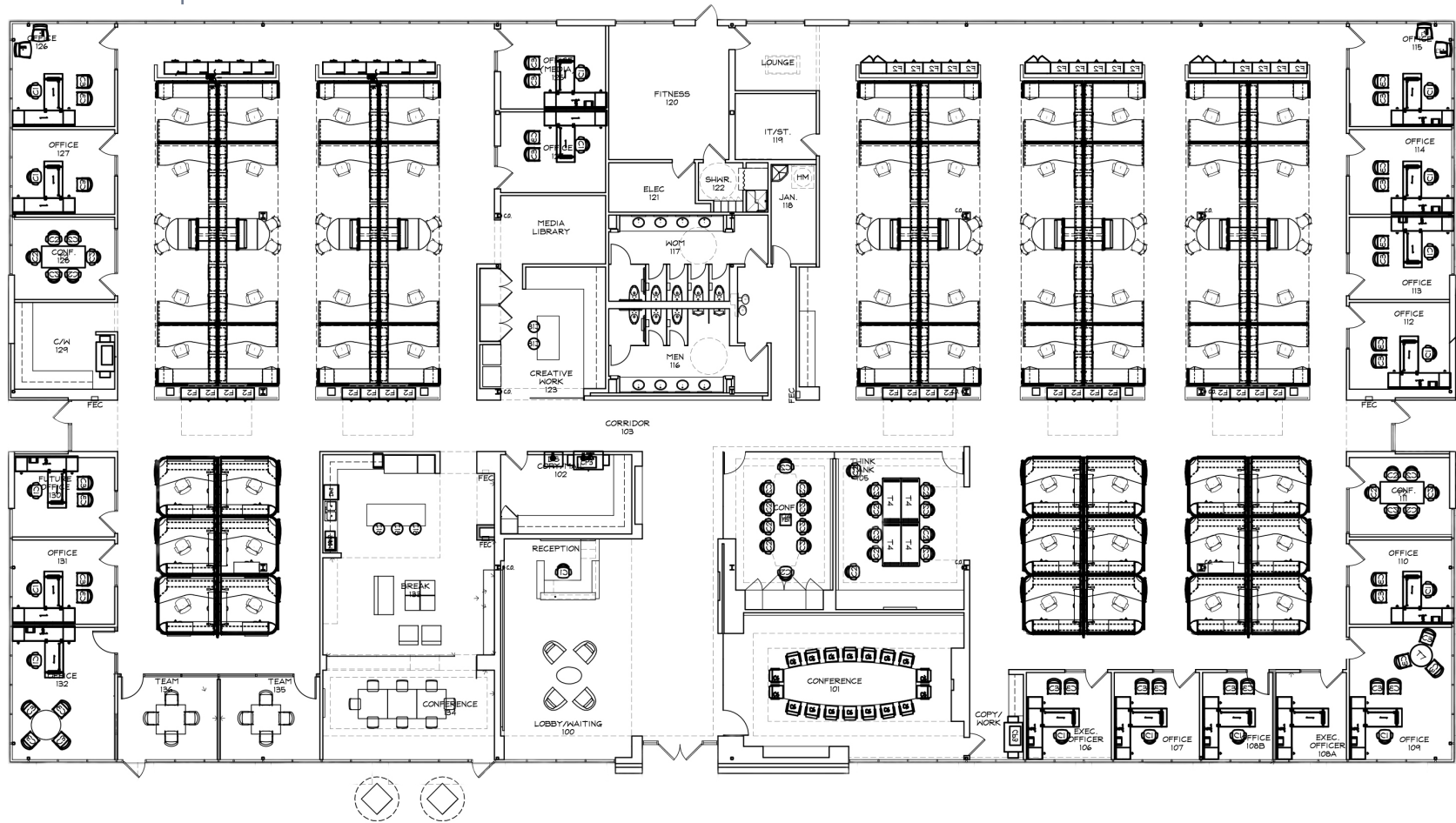

Mix of PRIVATE and OPEN offices with LOUNGE areas + FITNESS center

Immense NATURAL LIGHT with FLOOR-TO-CEILING WINDOWS on the perimeter of the building



Ideal work environment of PRIVATE and COLLABORATIVE SPACES

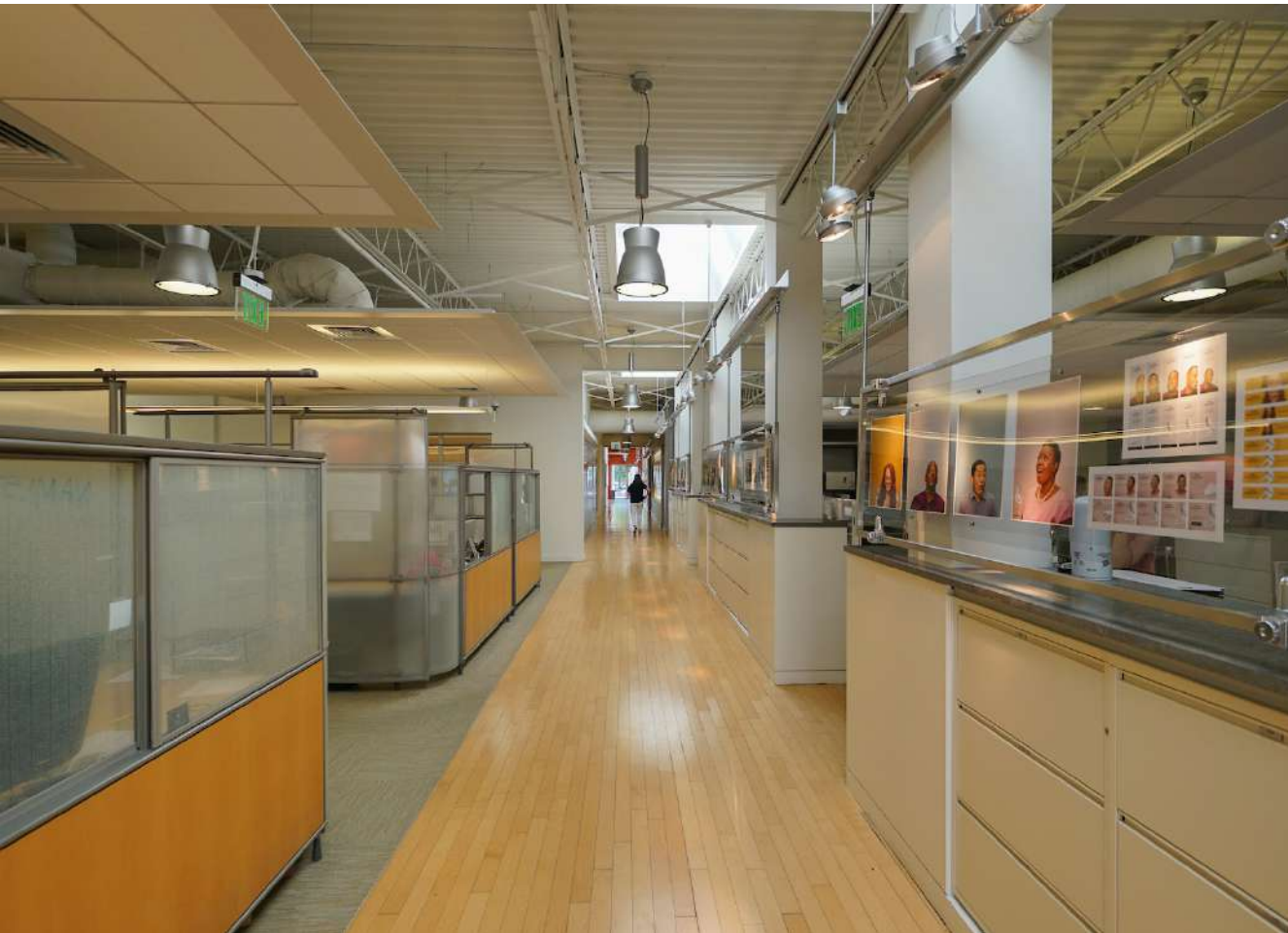



MIDTOWN SCENE



CONVENIENCE

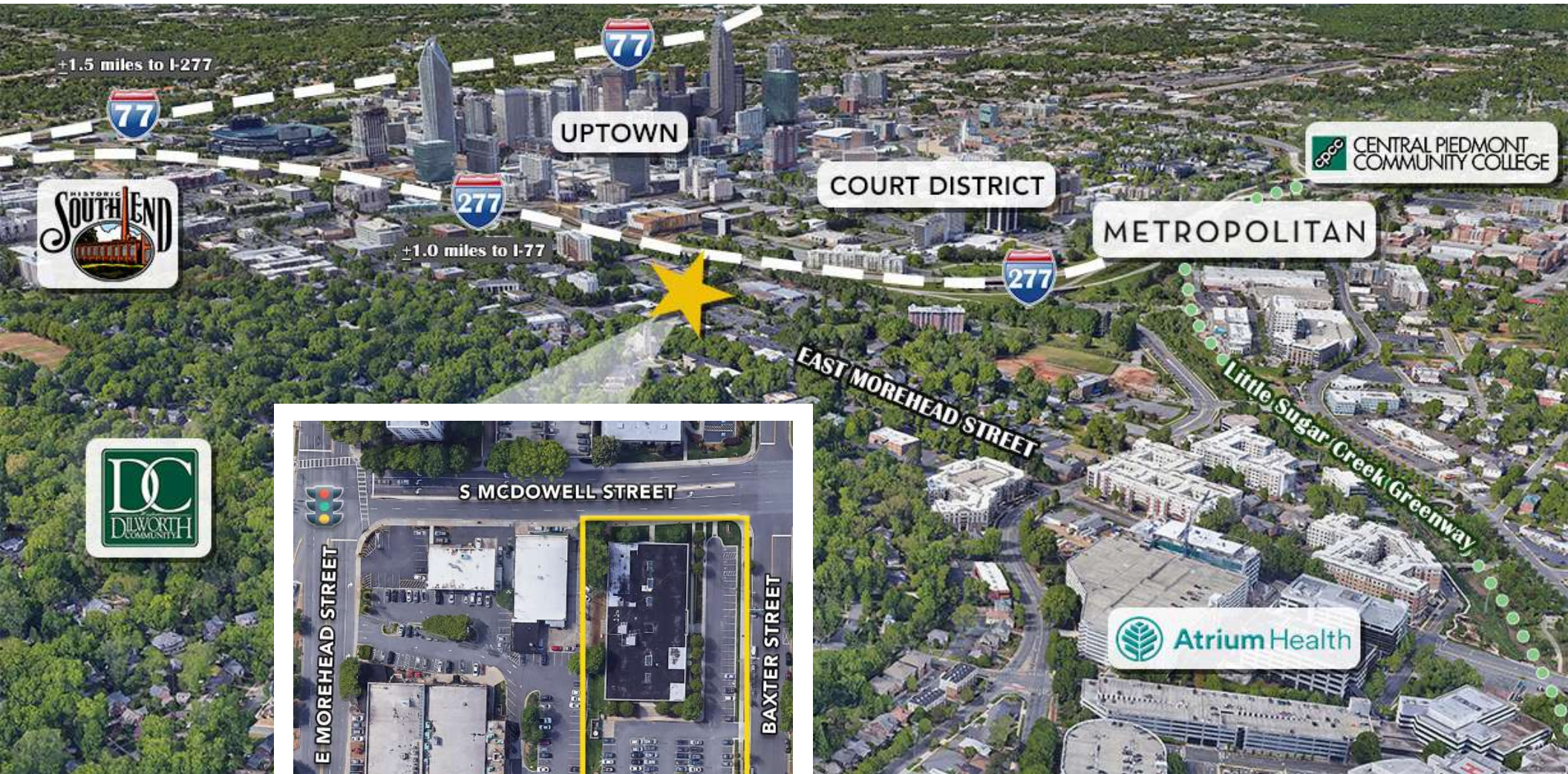



Meaningful **BRANDING OPPORTUNITIES** visible from the vibrant **MCDOWELL STREET** corridor into Uptown

900 BAXTER STREET
CHARLOTTE, NC 28204



FOR MORE INFORMATION, CONTACT:

ERIN SHAW

704.926.1414 (d) erin@beacondevelopment.com

500 East Morehead Street | Suite 200 | Charlotte, NC 28202

www.beacondevelopment.com

KRISTY VENNING

704.926.1409 (d) kristy@beacondevelopment.com

500 East Morehead Street | Suite 200 | Charlotte, NC 28202

www.beacondevelopment.com

