

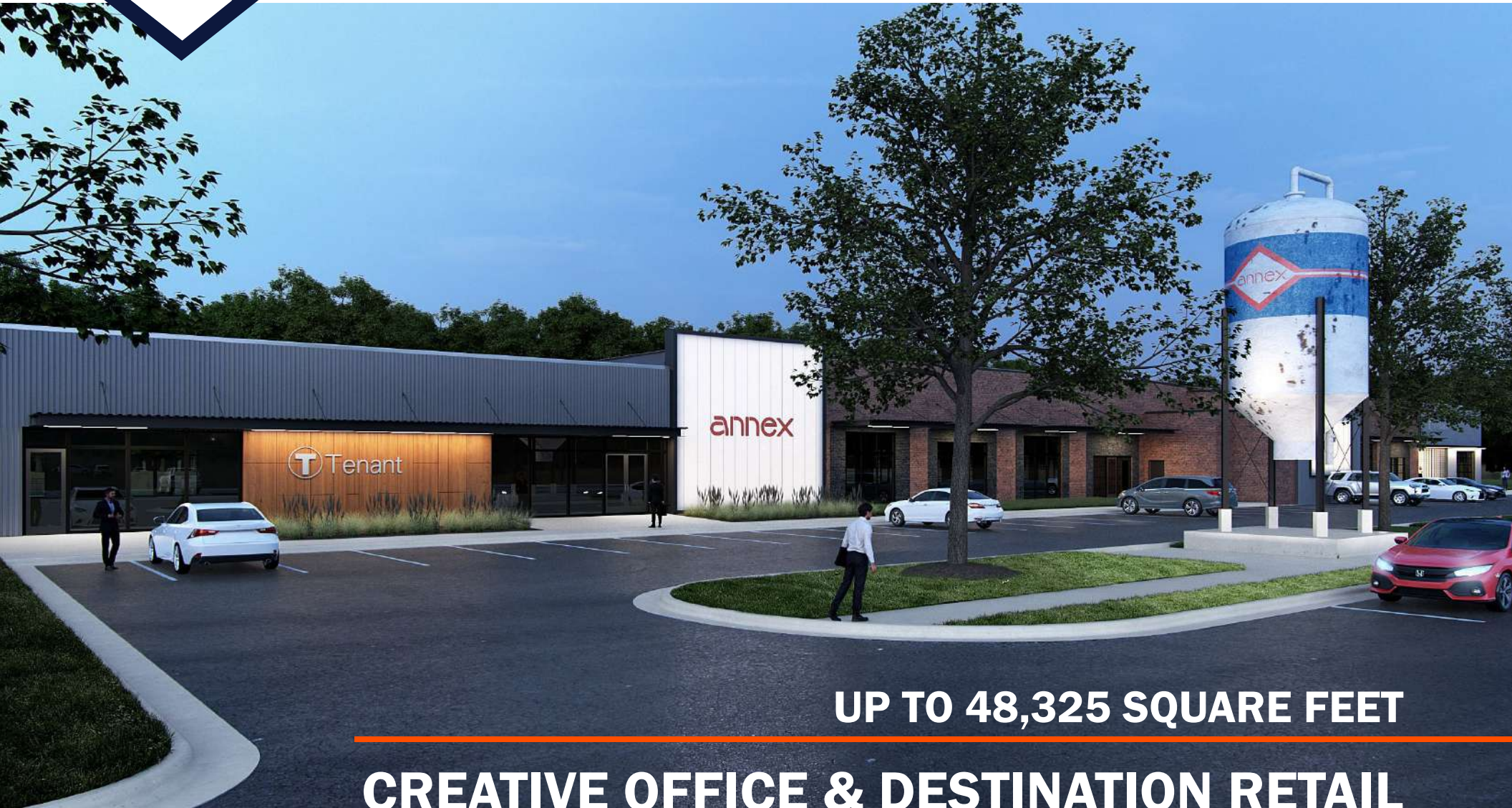

FREEMORE WEST

800 Gesco Street, Charlotte, NC 28208



UP TO 48,325 SQUARE FEET

CREATIVE OFFICE & DESTINATION RETAIL

FOR MORE INFORMATION, PLEASE CONTACT:

ERIN SHAW
BEACON PARTNERS
704.926.1414
ERIN@BEACONDEVELOPMENT.COM

KRISTY VENNING
BEACON PARTNERS
704.926.1409
KRISTY@BEACONDEVELOPMENT.COM



BEACON PARTNERS
500 EAST MOREHEAD STREET, SUITE 200
CHARLOTTE | NORTH CAROLINA 28202
704.597.7757 | BEACONDEVELOPMENT.COM



FREEMORE WEST

800 GESCO STREET, Charlotte, NC 28208



History of The Annex

Constructed in 1952, and expanded in 1968, 800 Gesco Street was originally developed for Clorox and used as a bleach manufacturing center before being purchased in the '80s by Plyler Paper Products, where it served recycling and sortation center.

The original structure has great bones, including a terracotta masonry structure with a wooden roof truss system and built-in skylights. Today, Beacon is taking the building from industrial to a creative office/destination retail, and rebranding it as "The Annex."

The Annex Overview

- Situated at the intersection of Gesco St and Tuckasegee Rd, The Annex is ideally suited for tenants seeking unique, well-located space within the FreeMore-West Neighborhood, just north of Uptown
- Flexible outdoor space
- There is vacant parcel of land located directly across from the project that can be redeveloped for additional parking
- Less than one mile from Uptown Charlotte, The Annex is within immediate vicinity of Seversville
- Available April 2020

FOR MORE INFORMATION, PLEASE CONTACT:

ERIN SHAW
 BEACON PARTNERS
 704.926.1414
ERIN@BEACONDEVELOPMENT.COM

KRISTY VENNING
 BEACON PARTNERS
 704.926.1409
KRISTY@BEACONDEVELOPMENT.COM



BEACON PARTNERS
 500 EAST MOREHEAD STREET, SUITE 200
 CHARLOTTE | NORTH CAROLINA 28202
 704.597.7757 | BEACONDEVELOPMENT.COM



FREEMORE WEST

800 Gesco Street, Charlotte, NC 28208

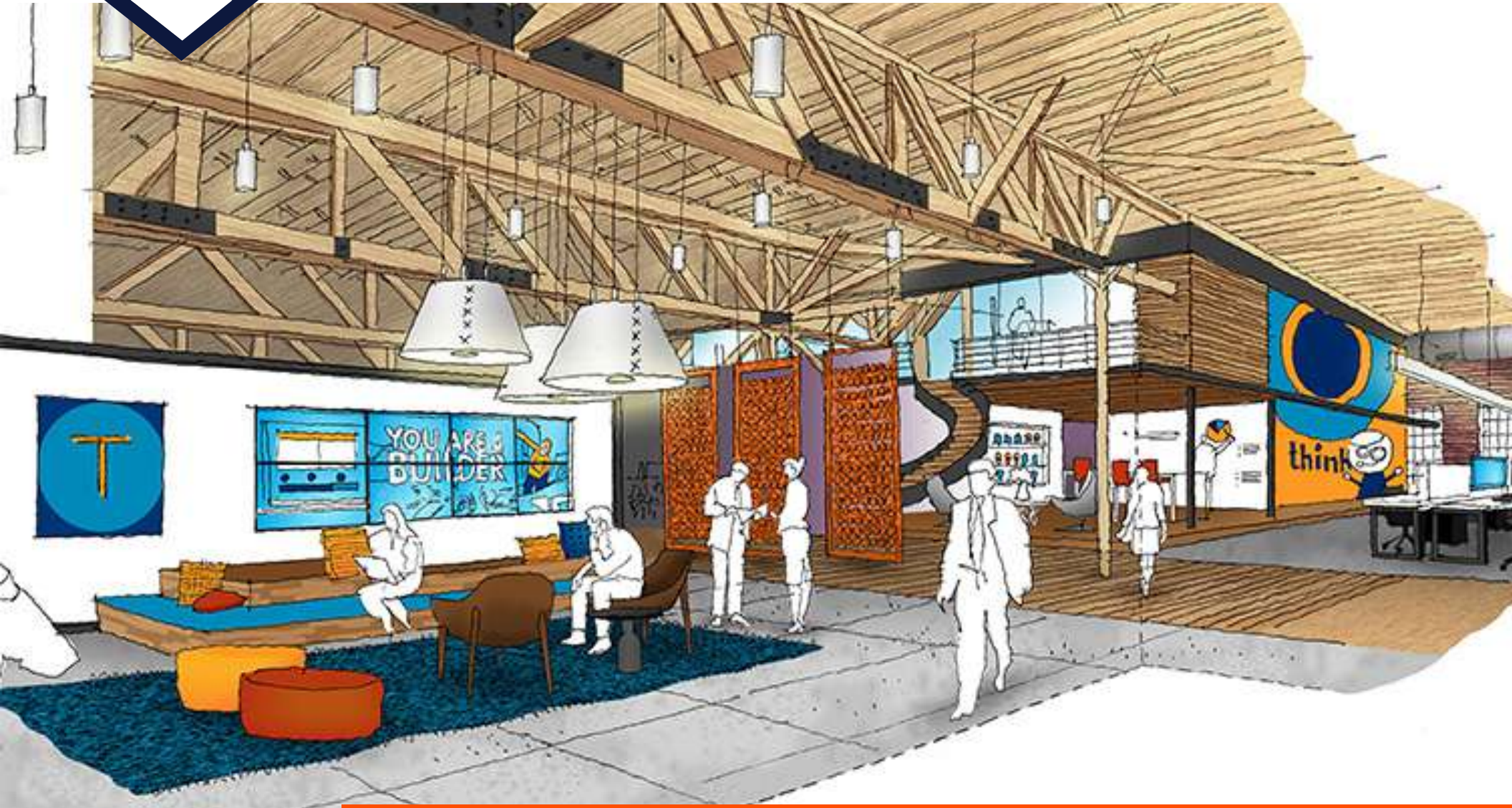

FOR MORE INFORMATION, PLEASE CONTACT:

ERIN SHAW
BEACON PARTNERS
704.926.1414
ERIN@BEACONDEVELOPMENT.COM

KRISTY VENNING
BEACON PARTNERS
704.926.1409
KRISTY@BEACONDEVELOPMENT.COM



BEACON PARTNERS
500 EAST MOREHEAD STREET, SUITE 200
CHARLOTTE | NORTH CAROLINA 28202
704.597.7757 | BEACONDEVELOPMENT.COM



FREEMORE WEST
800 Gesco Street, Charlotte, NC 28208



ADAPTIVE RE-USE



DELIVERING 04.2020



FOR MORE INFORMATION, PLEASE CONTACT:

ERIN SHAW
BEACON PARTNERS
704.926.1414
ERIN@BEACONDEVELOPMENT.COM

KRISTY VENNING
BEACON PARTNERS
704.926.1409
KRISTY@BEACONDEVELOPMENT.COM



BEACON PARTNERS
500 EAST MOREHEAD STREET, SUITE 200
CHARLOTTE | NORTH CAROLINA 28202
704.597.7757 | BEACONDEVELOPMENT.COM