

# BOXER BUILDING

1000 W. MOREHEAD STREET | SUITE G-100 | CHARLOTTE, NC 28208



## OFFICE SPACE IN SOUTH END FOR LEASE

**±6,092 SF**

- Move in ready, creative, open office space
- Tall exposed ceilings with large windows
- The Boxer Building is listed in the National Register Historic Places, Built in 1927
- Free on-site parking
- Highly visible with immediate access to I-77, I-277, near Uptown, South End, and FreeMoreWest
- Within walking distance to Bank of America Stadium
- Beacon leases and manages over 1 million SF in Midtown and South End areas

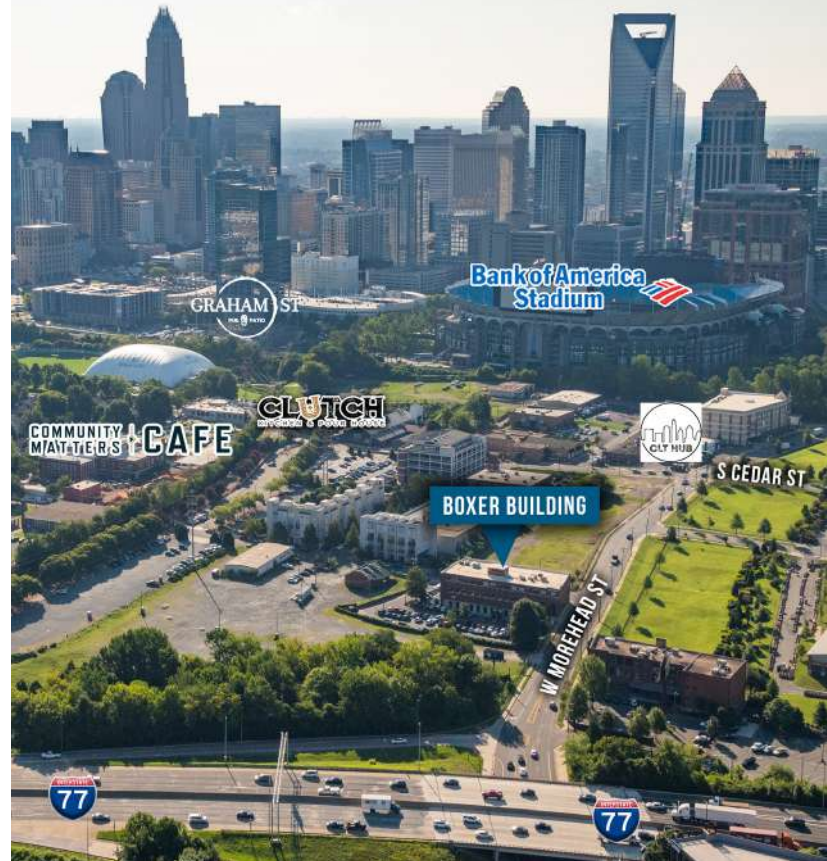

FOR MORE INFORMATION, CONTACT:

**CLAIRE SHEALY**

704.926.1409 | [claire@beacondevelopment.com](mailto:claire@beacondevelopment.com)

500 East Morehead Street | Suite 200 | Charlotte, NC 28202

[www.beacondevelopment.com](http://www.beacondevelopment.com)



# BOXER BUILDING

1000 W. MOREHEAD STREET | SUITE G-100 | CHARLOTTE, NC 28208

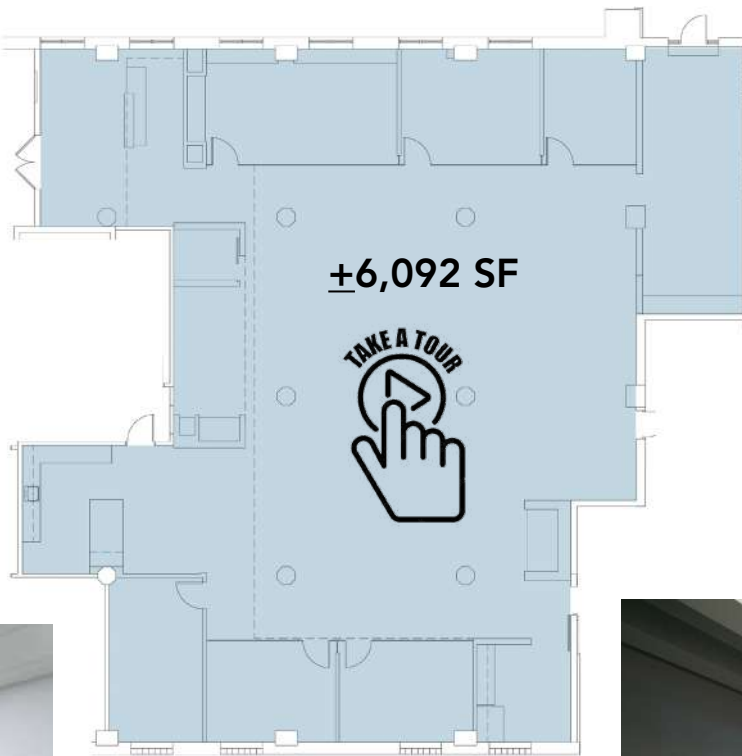

FOR MORE INFORMATION, CONTACT:

**CLAIRE SHEALY**

704.926.1409 | [claire@beacondevelopment.com](mailto:claire@beacondevelopment.com)

500 East Morehead Street | Suite 200 | Charlotte, NC 28202

[www.beacondevelopment.com](http://www.beacondevelopment.com)

