

CEDAR HILL

800 W. HILL STREET | SUITE 300 | CHARLOTTE, NC 28208



HISTORIC OFFICE SPACE AVAILABLE

16,751 SF

- Third floor available; open creative space
- A premier five-story historic brick building; built in 1926
- Free surface parking: 3 per 1,000
- Located off of Morehead Street at the corner of Cedar Street and Hill Street; directly next to Bank of America Stadium
- Exposed brick, expansive ceilings with floor-to-ceiling-glass
- Incredible views of Uptown and BofA stadium, large rooftop deck, free parking
- Beacon Partners owns, leases and manages over 1 million SF in Midtown and South End



FOR MORE INFORMATION, CONTACT:

KRISTY VENNING

704.926.1409 | kristy@beacondevelopment.com

500 East Morehead Street | Suite 200 | Charlotte, NC 28202

www.beacondevelopment.com



CEDAR HILL

800 W. HILL STREET | SUITE 300 | CHARLOTTE, NC 28208

FLOOR PLAN:

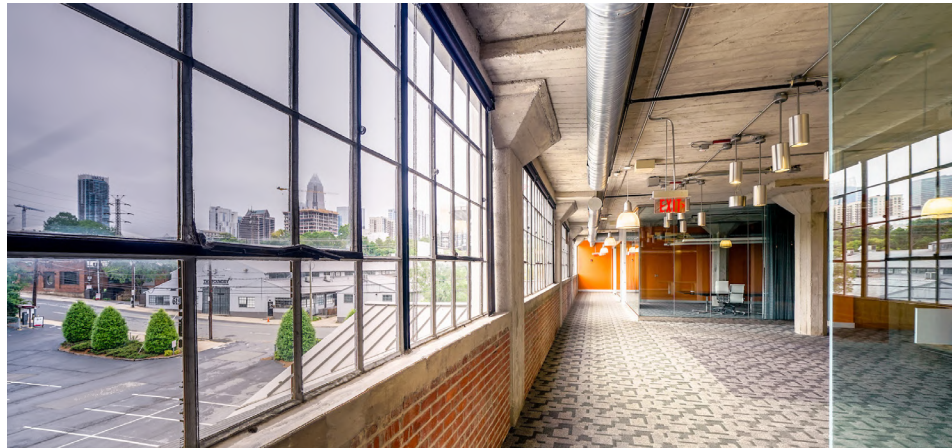
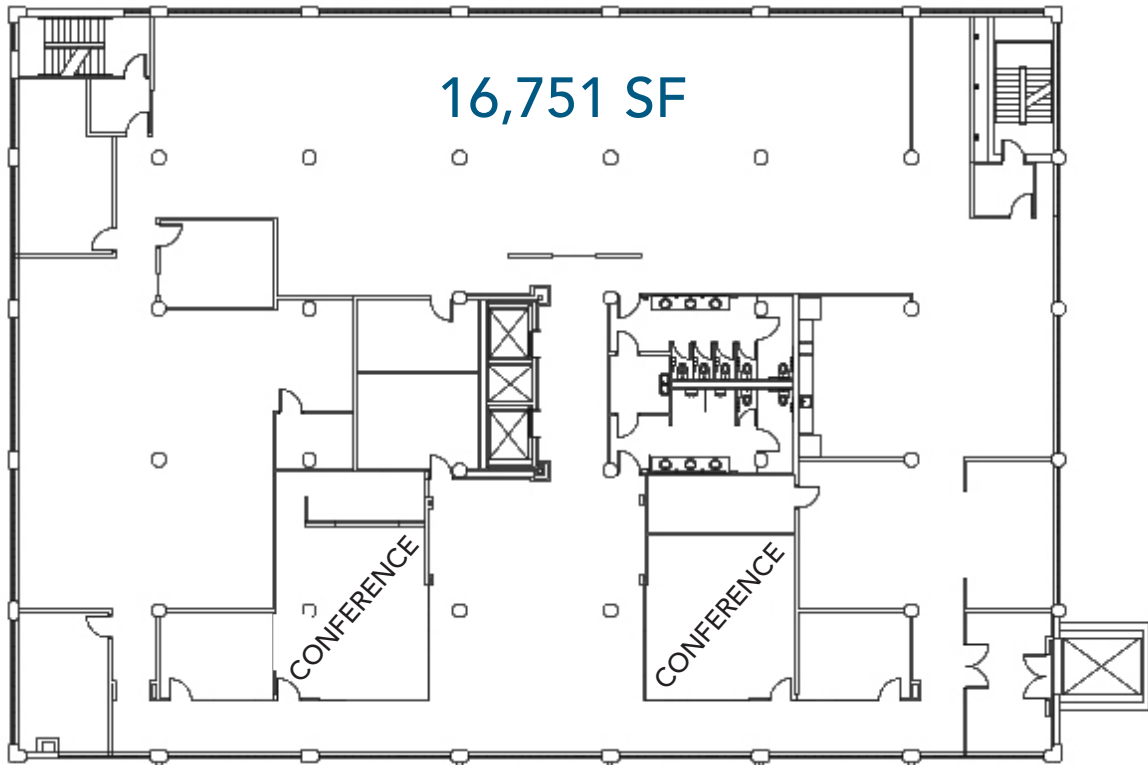

FOR MORE INFORMATION, CONTACT:

KRISTY VENNING

704.926.1409 | kristy@beacondevelopment.com

500 East Morehead Street | Suite 200 | Charlotte, NC 28202

www.beacondevelopment.com

