

# 10,200 SF WAREHOUSE FOR LEASE | CENTRAL CHARLOTTE

ATANDO BUSINESS PARK | 1309 UPPER ASBURY AVENUE | CHARLOTTE, NC 28206



## FEATURES:

- $\pm 10,200$  SF multi tenant warehouse facility with  $\pm 840$  SF office
- Wet sprinkler system
- 19' clear height
- 2 (8'x 10') dock high doors
- Solid brick on block construction
- Locally owned and managed professional park, with direct access from I-77 at Atando Ave/LaSalle St (Exit 12) and I-85 (Exit 40)
- Ideal Central Charlotte location:
  - $\pm 1$  mile to UPS facility
  - $\pm 1.5$  miles to I-77 (Exit 12)
  - $\pm 1.0$  miles to I-85 (Exit 40)
  - $\pm 2.0$  miles to Charlotte CBD

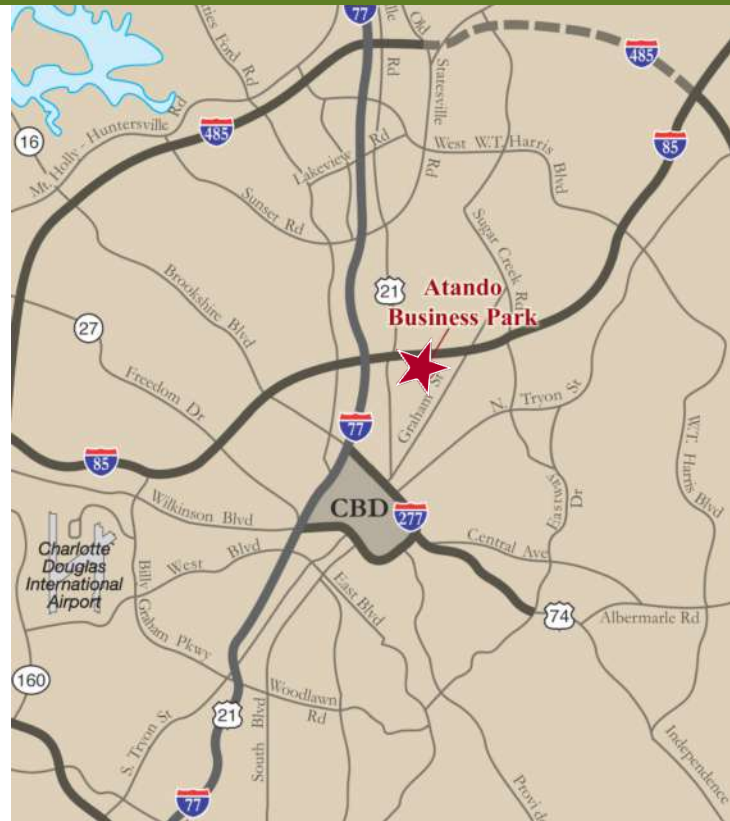

FOR MORE INFORMATION, CONTACT:

**JACK RIAZZI**

704.926.1412 (d) | [jack@beacondevelopment.com](mailto:jack@beacondevelopment.com)

500 E. Morehead Street, Suite 200 | Charlotte, NC 28202

[www.beacondevelopment.com](http://www.beacondevelopment.com)



# 10,200 SF WAREHOUSE FOR LEASE | CENTRAL CHARLOTTE

ATANDO BUSINESS PARK | 1309 UPPER ASBURY AVENUE | CHARLOTTE, NC 28206

## SITE & BUILDING PLAN

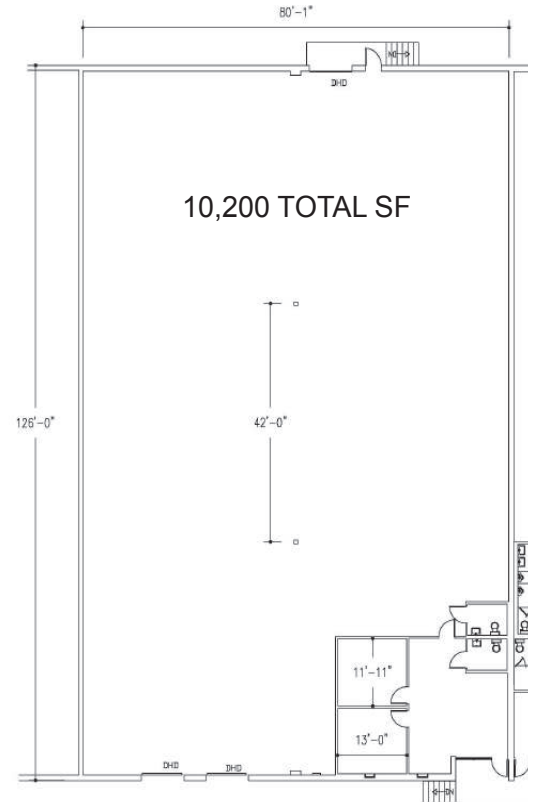
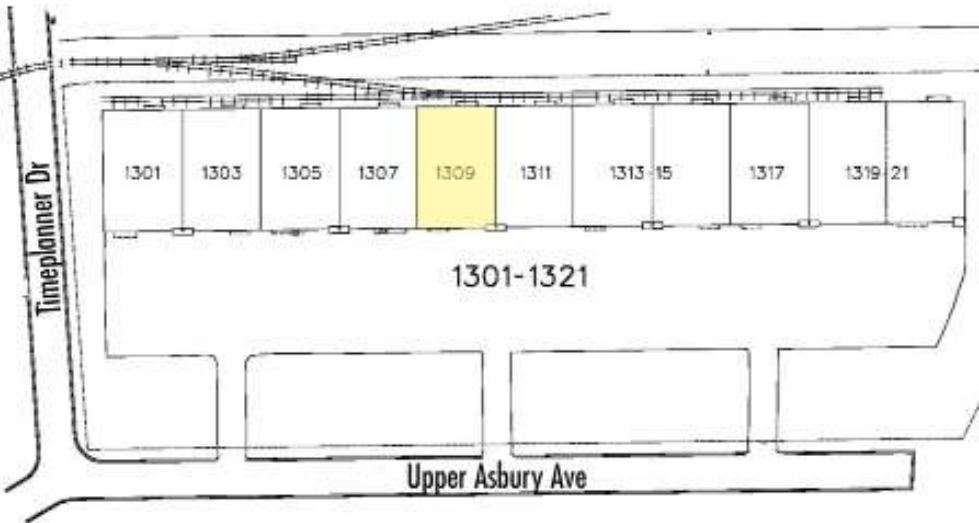

## AERIAL



FOR MORE INFORMATION, CONTACT:

**JACK RIAZZI**

704.926.1412 (d) | [jack@beacondevelopment.com](mailto:jack@beacondevelopment.com)

500 E. Morehead Street, Suite 200 | Charlotte, NC 28202

[www.beacondevelopment.com](http://www.beacondevelopment.com)

