

COMMERCE PARK

+/-30,000 SF WAREHOUSE | FOR LEASE

11626 WILMAR BLVD, SUITE D | CHARLOTTE, NC 28273



FEATURES:

- ±30,000 SF front-load, rail served facility
- ±2,654 SF office space
- I-2 zoning with outside storage
- Wet sprinkler
- 20' ceiling height
- Five (5) 10' x 10' Dock High Doors, 2 with pit levelers;
One (1) 10' x 10' Drive In Door
- Brick on block construction
- Easy access to Westinghouse Blvd and numerous amenities
- Conveniently located in Commerce Park, a master-planned park in Southwest Charlotte:
 - ±1 mile to I-77
 - ±1.5 miles to I-485
 - ±10 miles to CLT Airport

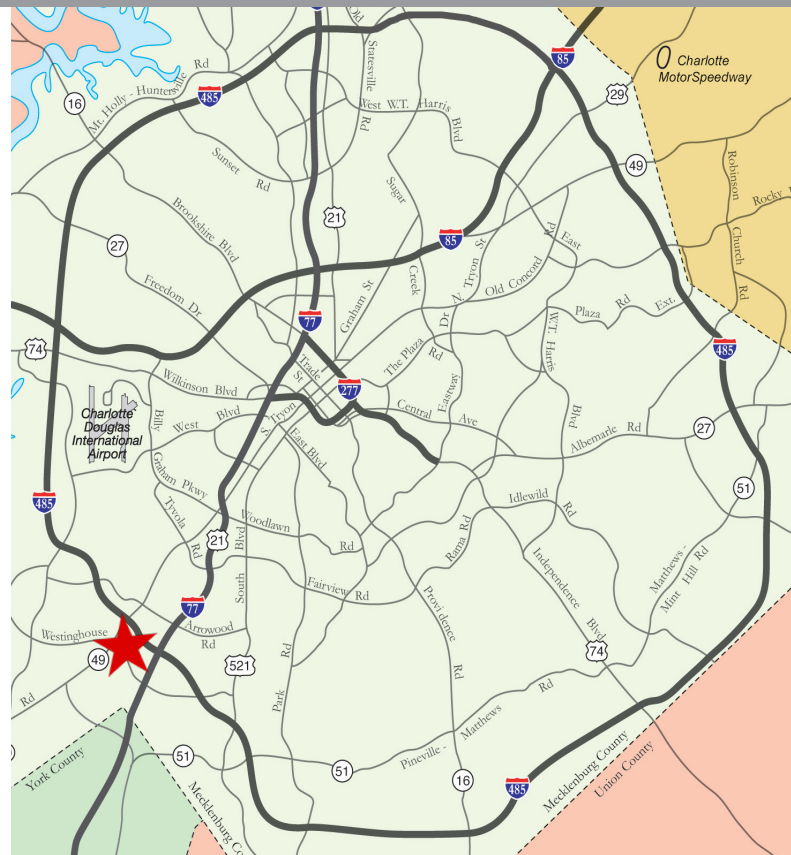

FOR MORE INFORMATION, CONTACT:

TIM ROBERTSON

704.926.1405 (d) | 704.597.7757 (m)

tim.robertson@beacondevelopment.com

500 East Morehead Street | Suite 200 | Charlotte, NC 28202 | www.beacondevelopment.com



**BEACON
PARTNERS**

COMMERCE PARK

+/-30,000 SF WAREHOUSE | FOR LEASE

11626 WILMAR BLVD, SUITE D | CHARLOTTE, NC 28273

SITE PLAN:



FLOOR PLAN:

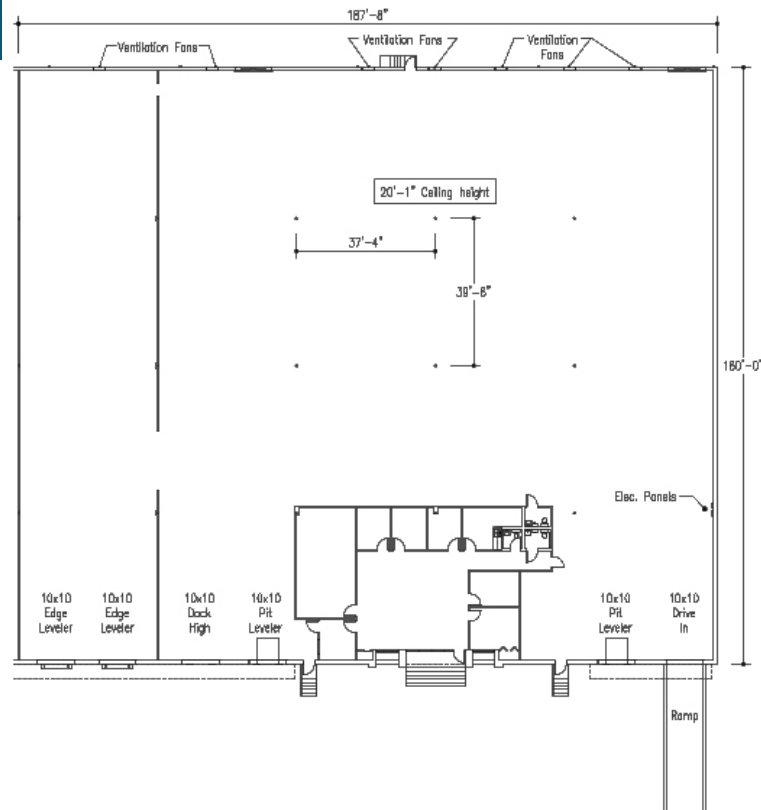

FOR MORE INFORMATION, CONTACT:

TIM ROBERTSON

704.926.1405 (d) | 704.597.7757 (m)

tim.robertson@beacondevelopment.com

500 East Morehead Street | Suite 200 | Charlotte, NC 28202 | www.beacondevelopment.com



**BEACON
PARTNERS**

All information regarding the property was obtained from sources deemed reliable but no warranty or representation is made of the accuracy thereof, and the property is subject to prior sale, lease or withdrawal.